

All dimensions to be checked on site. Figured dimensions take preference over scaled dimensions. Any errors or discrepancies to be reported to the Architects. This drawing may not be edited or modified by the recipient.

Copyright and ownership of this drawing is vested in RKD Architects, whose prior written consent is required for its use, reproduction or for publication to any third party. All rights reserved by the law of copyright and by international copyright conventions are reserved to RKD Architects and may be protected by court proceedings for damages and/or injunctions and costs. RKD Architects' Quality Management Systems are certified to ISO 9001:2015.

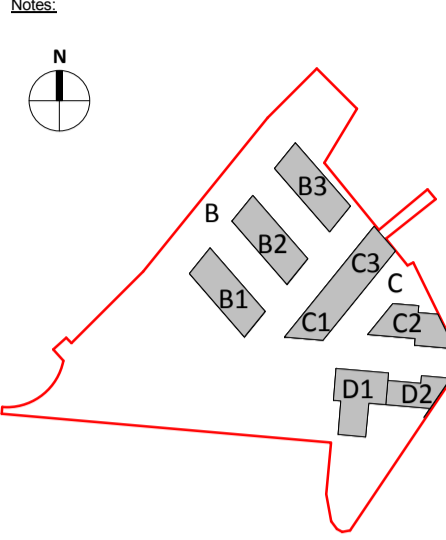

— SITE BOUNDARY

Notes:  
All coordinates relate to the Irish Transverse Mercator (ITM) and are displayed in meters (m).  
All levels relate to Malin Head datum.  
All dimensions are given in millimeters (mm).

USE
STUDIO APARTMENT
1 BED APARTMENT
2 BED APARTMENT
3 BED APARTMENT
INTERNAL RESIDENTIAL AMENITIES
RETAIL
COMMUNITY
HOTEL
OFFICE
ANCILLARY USE

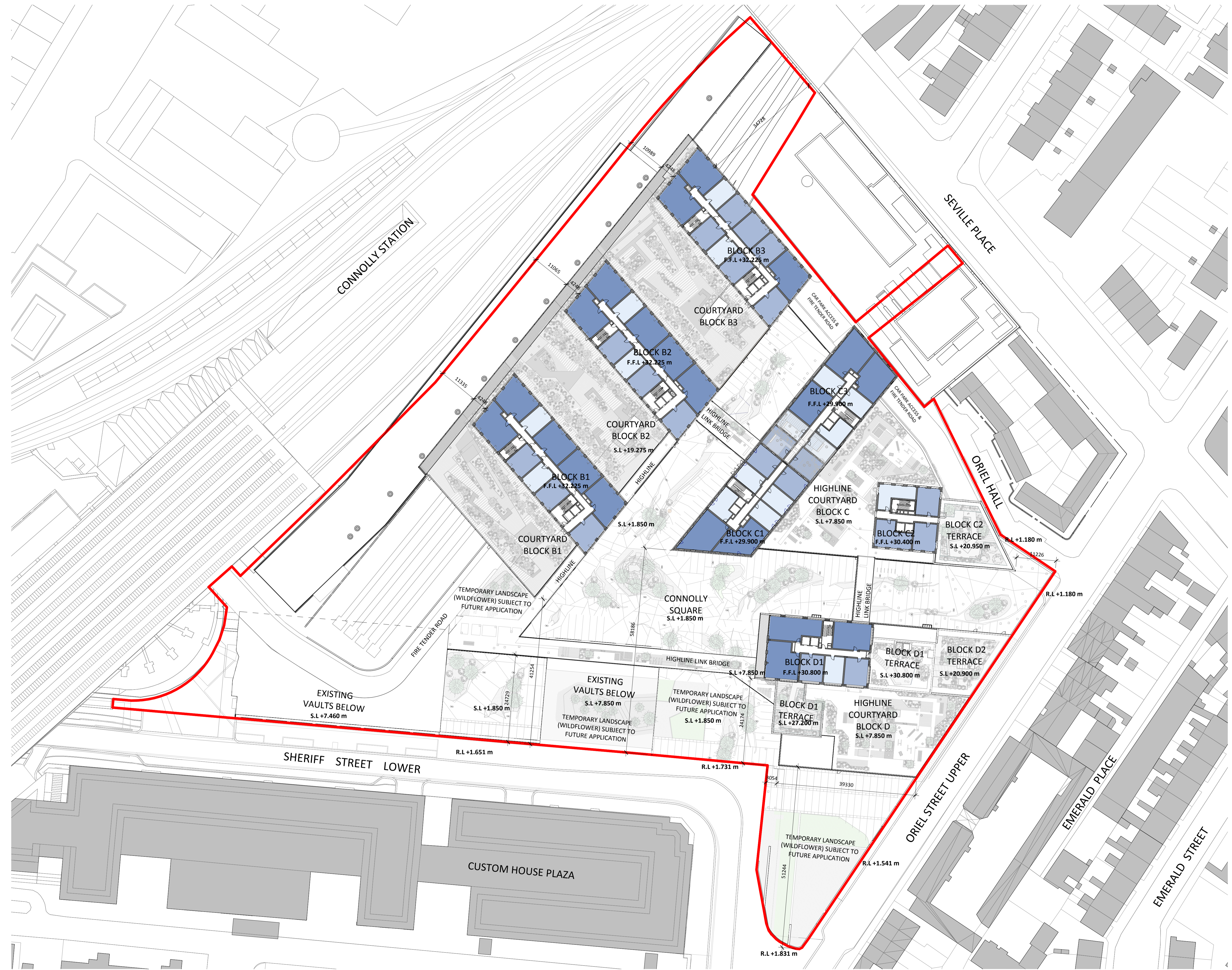

Rev.	Date	Description
A	OCT 2019	Issued for Planning Application Submission

STATUS	PLANNING
PROJECT	THE CONNOLLY QUARTER
PROJECT ADDRESS	Lands to the Rear of Connolly Station, Dublin 1
DWG TITLE	SITE LAYOUT PLAN LEVEL 08
DWG NO.	18135-RKD-00-08-DR-A-1012

REV.	PROJECT NO.	SCALE
A	18135	1 : 500

**RKD**  
 59 Northumberland Rd  
 Ballsbridge, Dublin 4  
 D04 WFB6, Ireland  
 +353 1 668 1055  
 info@rkd.ie  
 rkd.ie

**ARROW**  
 Name: Farinagade 13, st th  
 DK-1364 Copenhagen K  
 Denmark  
 +45 4226 2860  
 info@arrowarchitects.com  
 www.arrowarchitects.com

1 SITE LAYOUT PLAN - LEVEL 08  
1 : 500